





SITUACIJA URBANISTIČKE PARCELE BR.31  
IZMJENA I DOPUNA DUP " ULCINJ GRAD " ZA LOKALITET "MERAJA 2"

Urbanistička parcela br:31=608m<sup>2</sup>

R=1:250  
-Prikazane kote su apsolutne

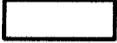
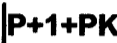
katastarska parcela br.1449/3=31.00m<sup>2</sup> L.N.6708 Harasani Ibrahim 1/2 i Harasani Ramazan 1/2  
katastarske parcele br:1451/4=35.00m<sup>2</sup> L.N.6708 Harasani Ibrahim 1/2 i Harasani Ramazan 1/2  
katastarske parcele br:1451/5=367.00m<sup>2</sup> L.N.6708 Harasani Ibrahim 1/2 i Harasani Ramazan 1/2  
katastarske parcele br:1451/6=175.00m<sup>2</sup> L.N.6708 Harasani Ibrahim 1/2 i Harasani Ramazan 1/2

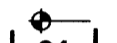
LEGENDA:

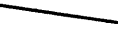
-  urbanistička parcela
-  planirana spratnost
-  katastarska parcela
-  površine za individualno stanovanje (porodično)
-  nivoelacija saobraćajnica
-  broj urbanističke parcele sa novoplaniranim objektom

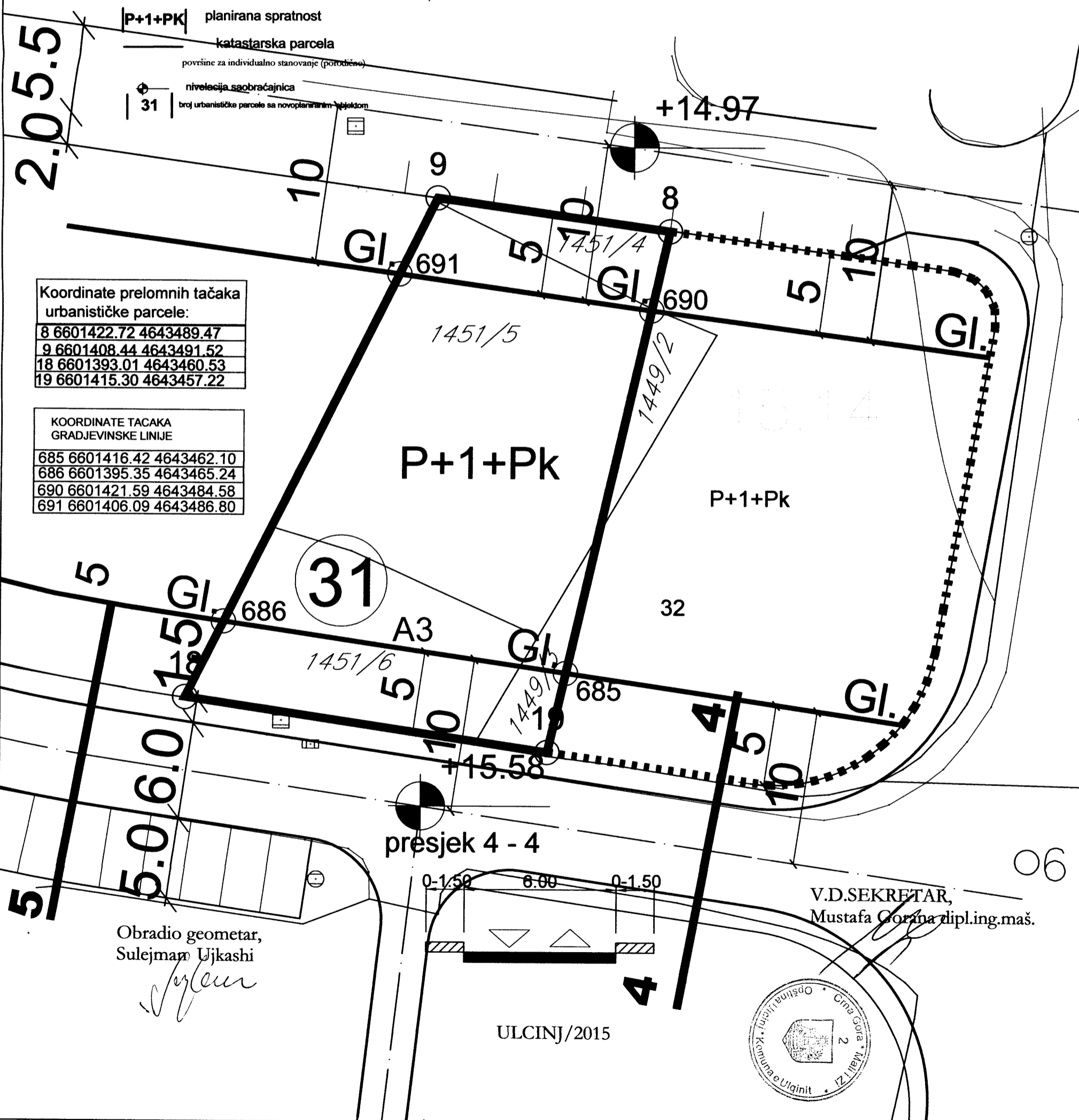

Koordinate prelomnih tačaka urbanističke parcele:

8	6601422.72	4643489.47
9	6601408.44	4643491.52
18	6601393.01	4643460.53
19	6601415.30	4643457.22

KOORDINATE TACAKA GRADJEVINSKE LINIJE

685	6601416.42	4643462.10
686	6601395.35	4643465.24
690	6601421.59	4643484.58
691	6601406.09	4643486.80

Obradio geometar,  
Sulejman Ujkashi  
*Sulejman Ujkashi*

V.D.SEKRETAR,  
Mustafa Gorina dipl.ing.maš.

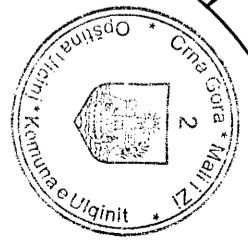

ULCINJ/2015