

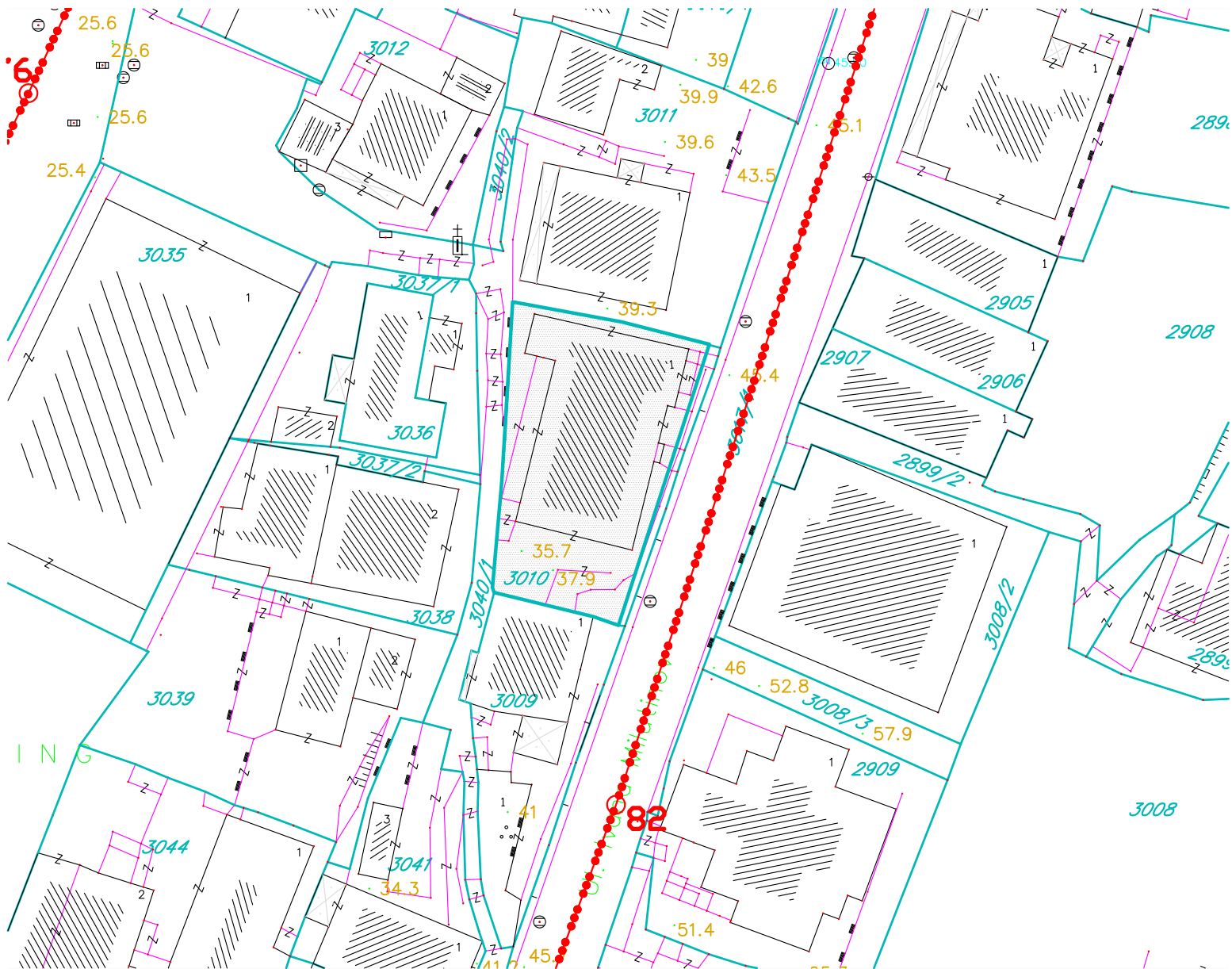



Izmjene i dopune za određene urbanističke i katastarske parcele DUP-a "Ulcinj-Grad" za lokalitet "Pristan"

Postojeće stanje
GEODETSKA PODLOGA
k.p 3010

R=1:500

1.6



-  granica Plana
-  granica kat.parcele
-  oznaka kat. parcele
-  gradjevinska linija

Obradivač:
INKOPLAN d.o.o.- Podgorica
Maj 2015. godine

Investitor
OPŠTINA ULCINJ